

Battery Room Survey

Dealer/Customer: _____

Survey Performed By: _____

Project: _____

Date: _____

Safety Product Requirements	Recommended BHS Products	Sample Illustrations	Regulations
<p>Drip Pans Approved method and materials for control of electrolyte spill</p> <ul style="list-style-type: none"> <input type="checkbox"/> Is spill control present? <input type="checkbox"/> Are acid absorbent mats present in drip pans? 	<p>DK-SS UP-424</p>		<p>IFC 608.5 NFPA 1 Article 52 UFC Article 64 6404.4 OSHA 28 CFR 1926.441(a)(4)</p>
<p>Spill Kits Spill Kits are required for use by first responders. Kits should contain Personal Protective Equipment (PPE) for corrosive chemical protection, neutralizers and items to facilitate clean-up. Approved method to neutralize spilled electrolyte to a level of pH 7.0 to pH 9.0.</p> <ul style="list-style-type: none"> <input type="checkbox"/> Is a Spill Kit present? <input type="checkbox"/> Is Spill Kit complete (if not, indicate contents below)? <input type="checkbox"/> Apron <input type="checkbox"/> Gloves <input type="checkbox"/> Face Shield <input type="checkbox"/> Goggles <input type="checkbox"/> Tyvex Coveralls <input type="checkbox"/> Acid Resistant Boots <input type="checkbox"/> Neutrasorb <input type="checkbox"/> SOC's or Pillows <input type="checkbox"/> Shovel <input type="checkbox"/> pH Test Kit <input type="checkbox"/> Other: _____ 	<p>SK-6 SK-20 SK-55 SK-CAB</p>		<p>IFC 608.5</p>
<p>Safety Protection Gear PPE is required when entering battery rooms and working on battery systems.</p> <ul style="list-style-type: none"> <input type="checkbox"/> Eye protection (goggles) <input type="checkbox"/> Corrosive Resistant Gloves <input type="checkbox"/> HV Insulated Gloves <input type="checkbox"/> Corrosive Resistant Apron 	<p>PK-1200</p>		<p>OSHA 29 CFR 1910.133(a) OSHA 29 CFR 1926.28(a) NFPA 70E</p>
<p>Eye Wash / Shower Station Suitable facilities for quick drenching or flushing of the eyes and body. Note condition.</p> <ul style="list-style-type: none"> <input type="checkbox"/> Eyewash present? <input type="checkbox"/> Type: (Portable, Plumbed, Qt. Bottles, Personal, Other) _____ <input type="checkbox"/> Shower present? <input type="checkbox"/> Capacity (Portable): _____ <input type="checkbox"/> Does eyewash need maintenance? 	<p>PEW-700 EW-300 MEW-300 SEW-500 BES-1</p>		<p>OSHA 1910.151(c) OSHA 1926.441(a)(6)</p>

Safety Product Requirements	Recommended BHS Products	Sample Illustrations	Regulations
-----------------------------	--------------------------	----------------------	-------------

Training Program

Training shall be provided regarding the hazards of the equipment in their work area for ALL persons entering the battery room.

- Training program in place?
- Are training records documented?
- Is a training standard documented for personnel?
- Are all persons who access battery room trained on hazards?
- Have product manuals and operator training DVD been provided?
- Comments: _____



NFPA 70E 110.2

Battery Room Floors

Floors shall be of acid resistant construction unless protected from acid accumulations.

- Does battery room floor currently have an epoxy applied to the concrete floor?
- Is there damage to existing epoxy or concrete?
If yes, take photos.
- (Operator Aboard Battery Extractor application) Has defined travel path been profiled to verify the FMIN rating?

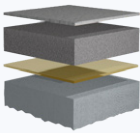

OSHA 1926.441(a)(4)

Cable Management

Charging apparatus shall be protected from damage by trucks.

- Is there any damage to the charger cables or connectors?
- Are the charger cables and connectors supported from resting on the battery stand or floor?

CWB
CWB-V1
CR-MT
CR-1
CR-M
CCR-12HD



OSHA 1926.441(b)(2)

Lifting Beam Staging Stand

Battery lifting devices shall be stored when not in use.

- Is there any damage to existing lifting beam?
- Is there a secure storage device for lifting beam while not in use?

CS-BLB



ASME B30.20-2003

The items referenced above are intended to assist in meeting the regulations referenced therein. Government regulations applicable to the use of BHS products vary from jurisdiction to jurisdiction. This survey should not be considered an exhaustive list of applicable regulations in your area. It is the responsibility of the end user to verify and maintain full compliance with all applicable regulations. Please consult legal counsel to determine the regulations applicable to your facility.

Comments:

